

# Alicia County Building Department

216 W. Main St.

Harrisville, MI 48740

989-724-9440 fax 989-724-9449

## OFFICE USE ONLY

Permit Number
Date Issued
Expiration Date
File Number

### PERMIT APPLICATION for Part 91 SOIL EROSION AND SEDIMENTATION CONTROL

\$ 185.00

EMAIL ADDRESS: \_\_\_\_\_

#### 1. APPLICANT (Please check if applicant is the landowner or designated agent\*)

Name	Landowner	Designated Agent
Address		
City	State	Zip Code
Area Code/Telephone Number		

#### 2. LOCATION

Section	Town	Range	Township	City/Village	County
Subdivision	Lot No.	Tax ID Number		Street Address:	
				Cross Streets:	

#### 3. PROPOSED EARTH CHANGE

Project Type:	Residential	Multi-family	Commercial
	Industrial	Land Balancing	
Describe Project:			Size of Earth Change (acres or square feet)
Name of and Distance to Nearest Lake, Stream, or Drain		Date Project to Start	Date Project to be Completed

#### 4. SOIL EROSION AND SEDIMENTATION CONTROL PLAN (Refer to Rule 323.1703)

Note: 1 complete sets of plans must be attached.	Estimated Cost of Erosion and Sediment Control
	Plan Preparer's Name and Telephone Number
	Area Code ( )

#### 5. PARTIES RESPONSIBLE FOR EARTH CHANGE

Name of Landowner (if not provided in Box No. 1 above)	Address		
City	State	Zip	Area Code/Telephone Number
Name of Individual "On Site" Responsible for Earth Change		Company Name	
Address	City	State	Zip Code
Area Code/Telephone Number			

#### 6. PERFORMANCE DEPOSIT (If required by the permitting agency)

Amount Required \$	Cash	Certified Check	Irrevocable Letter of Credit	Surety Bond
Name of Surety Company				
Address	City	State	Zip Code	Area Code/Telephone No.

I (we) affirm that the above information is accurate and that I (we) will conduct the above described earth change in accordance with Part 91, Soil Erosion and Sedimentation Control, of the Natural Resources and Environmental Protection Act, 1994 PA 451, as amended, applicable local ordinances, and the documents accompanying this application.

Landowner's Signature	Print Name	Date
Designated Agent's Signature*	Print Name	Date

\* Designated agent must have a written statement from landowner authorizing him/her to secure a permit in the landowner's name.

## **Check List for Soil Erosion Control Permit Application**

### *SOIL EROSION AND SEDIMENTATION CONTROL PLAN*

1. Scaled drawing.
2. Legal description.
3. Site location sketch.
4. Distance to lake, stream, wetland, etc.
5. Predominant land features.
6. Contour interval or slope description.
7. Description of soil types.
8. Description and limits of earth changes.
9. Drainage facilities.
10. Timing and sequence of earth change.
11. Description and location of control measures.
12. Maintenance plan.



(Sample Site Plan)

Lake or Stream \_\_\_\_\_

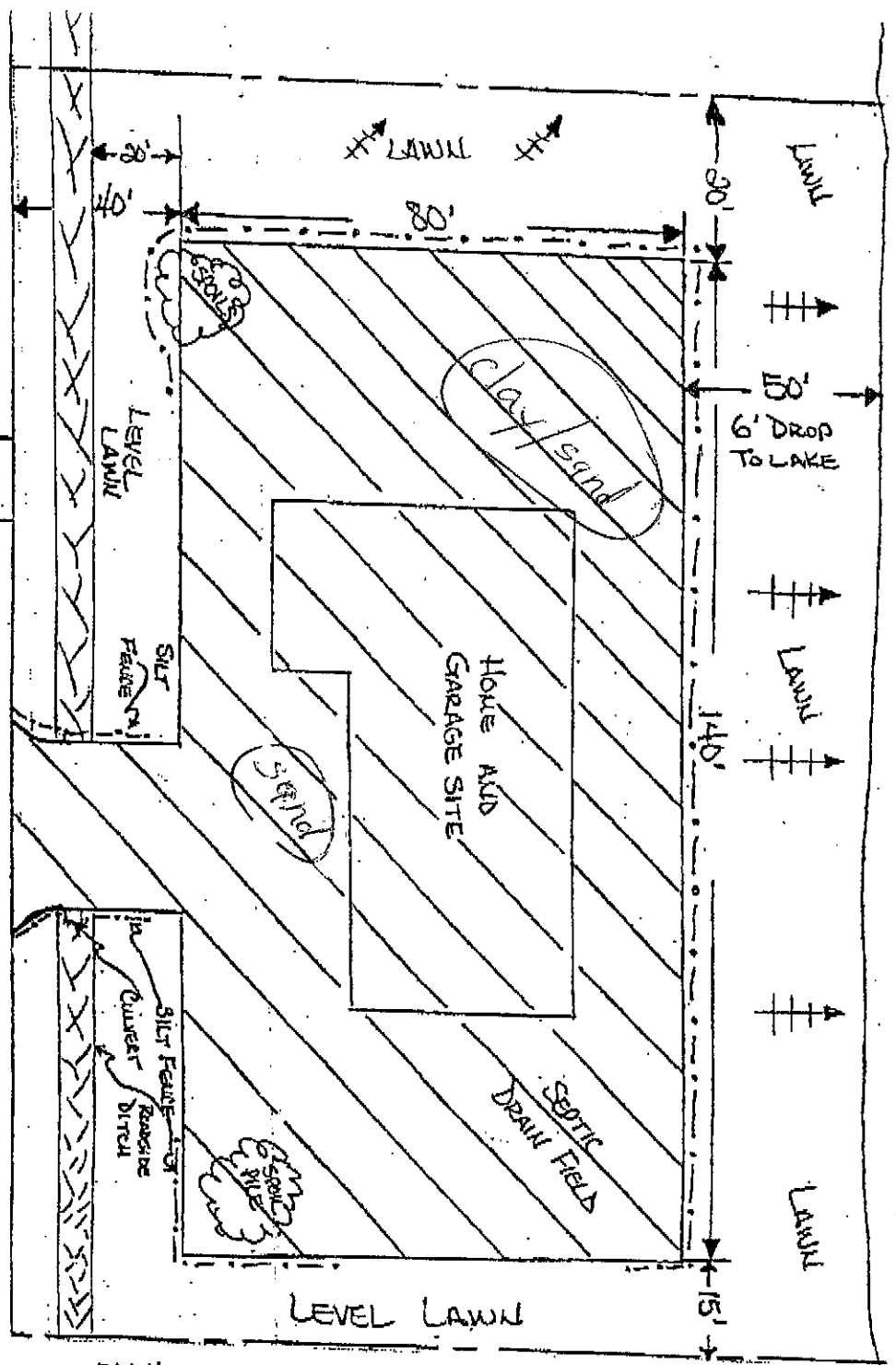

**LEGEND**

INDICATES DIRECTION OF DRAINAGE



INDICATES LOCATIONS OF EARTH CHANGE



SILT FENCE WHERE REQUIRED



**INFORMATION**

- a) Scaled Map
- b) Site location sketch
- c) Proximity to lake/stream
- d) Limits of earth change
- e) Predominant land features
- f) Slope information
- g) Soils information
- h) Drainage facilities
- i) Timing and sequence
- j) Temporary SESC measures
- k) Permanent SESC measures
- l) Maintenance program for SESC measures

Start \_\_\_\_\_

Finish \_\_\_\_\_



Michigan Department of Environmental Quality  
Land and Water Management Division

Regulated Activities Under the  
Natural Resources and Environmental Protection Act, 1994 PA 451, as Amended

- 1a. Does your project or activity involve an earth change that disturbs one or more acres of land or is located within 500 feet of a lake or stream? If yes, a Part 91 permit must be obtained from the county or local governmental agency. Note: Some counties and local agencies may require permits for other earth changes in addition to those described above; please check with them prior to undertaking any earth change. A list of Part 91 permitting agencies is available at www.deq.state.mi.us/lwm/ under the Water Management Section, Soil Erosion and Sedimentation Control Program.

Earth change means a human-made change in the natural cover or topography of land, including cut and fill activities, which may result in or contribute to soil erosion and sedimentation of the waters of the state. Earth change does not include the practice of plowing and tilling soil for the purpose of crop production.

Lake means "the Great Lakes and all natural and artificial inland lakes or impoundments that have definite banks, a bed, visible evidence of a continued occurrence of water, and a water surface area equal to, or greater than, one acre."

Stream means "a river, creek, or other surface water course which may or may not be serving as a drain, as defined in the drain code, and which has definite banks, a bed, and visible evidence of the continued flow or continued occurrence of water, including the connecting waters of the Great Lakes."

- 1b. Does your project or activity involve an earth change that is under the jurisdiction (crosses the boundaries) of two or more county and/or local Part 91 agencies described in 1a? (Part 91) ..... No  Yes

If your project or activity disturbs five or more acres, a stormwater permit is required from the Surface Water Quality Division (SWQD), Michigan Department of Environmental Quality (MDEQ). Please call 517-241-8993 for further information.

- 2. Is your project or activity in or near an inland lake or stream? (Parts 31 and 301) ..... No  Yes

Inland lake or stream means "a natural or artificial lake, pond, or impoundment; a river, stream, or creek which may or may not be serving as a county drain as defined by the drain code; or any other body of water that has definite banks, a bed, and visible evidence of a continued flow or continued occurrence of water . . . ." "Inland lake or stream does not include . . . a lake or pond that has a surface area of less than 5 acres."

- 3. Does your project or activity impact a wetland? (Part 303) ..... No  Yes

Wetland means "land characterized by the presence of water at a frequency and duration sufficient to support, and that under normal circumstances does support, wetland vegetation or aquatic life, and is commonly referred to as a bog, swamp, marsh . . . ."

If work in wetlands cannot be avoided, a permit from the MDEQ may be required; and wetland mitigation to compensate for the loss of the wetland and its functions may also be required. For questions regarding regulated wetlands, please contact your local LWMD Field Office or the Inland Lakes and Wetlands Unit at 517-373-1746.

The MDEQ's Wetland Assessment Program assists property owners in identifying wetlands on their property. For more information on the Wetland Assessment Program call 517-241-8485.

- 4. Is your project or activity in or adjacent to the Great Lakes? (Parts 323, 325, and 353) ..... No  Yes

- 5. Does your project or activity involve constructing, maintaining, or altering a dam? (Part 315).. No  Yes

Dam means "an artificial barrier, including dikes, embankments, and appurtenant works, that impounds, diverts, or is designed to impound or divert water or a combination of water or any other liquid or material in the water."

Effective Immediately, the State requires each Authorized Agent applying for a Soil Erosion Permit on behalf of another person to include a Statement authorizing, him / her to secure a permit. Please have the Landowner complete this Letter of Authorization to be submitted with the Application Form.

### LETTER OF AUTHORIZATION

\_\_\_\_\_ is Authorized to secure a Soil  
(name of Designated Agent)

Erosion Permit in my name for a project requiring said permit at :

\_\_\_\_\_  
(address of Project Location)

\_\_\_\_\_  
(additional information)

\_\_\_\_\_  
(Print Name of Landowner)

\_\_\_\_\_  
(Signature of Landowner)

\_\_\_\_\_  
(Date)